

TERRADISC

PÖTTINGER compact disc harrows





Revitalising the soil

TERRADISC disc harrows

The TERRADISC compact disc harrow is designed specifically for stubble cultivation and seedbed preparation. The compact design and aggressive disc angle ensure reliable penetration and excellent mixing in of harvest residues.

The short construction is a key feature of PÖTTINGER compact disc harrows. With the TERRADISC, you have a choice of working depths between 1.18 and 4.72" / 30 and 120 mm. The offset configuration of the aggressively set discs mixes the harvest residues effectively into the soil. They deliver optimum processing of your soil.

Contents

	Page
Rigid-framed compact disc harrows	5
Folding compact disc harrows	11
Trailed, folding compact disc harrows	12
TEGOSEM cover crop sowing system	16
Rear rollers	18
Technical data / Equipment	22

All information on technical data, dimensions, weights, output, etc. is approximate and is not binding.



TWIN ARM



A uniform surface finish with the best mixing performance meets farmer's and contractor's expectations in the field. To achieve this, PÖTTINGER has optimised the geometry, size, mounting angle and penetration angle of the discs. The result: Low draft, perfect ground penetration, best tilth and mixing effect.

TWIN ARM – the heart of the machine

Two solid forged carrier arms are welded to a very wide clamping bracket. This ensures that the discs always retain their position and angle. Even in heavy soil it is impossible for them to deviate to the side – hard wheel marks are broken up consistently.

The rugged scalloped discs made of special heat-treated steel have a diameter of 22.83" / 580 mm. Eight discs per metre of working width equate to a spacing of just 4.92" / 125 mm. The optimised interplay of ground penetration angle and mounting angle ensure perfect performance. The offset configuration of the aggressive discs mixes harvest residues effectively into the soil.



NONSTOP protection against stones

Proven over many years in the field, the maintenance-free NON STOP trip protection system features 1.57" / 40 mm thick rubber elements. The clamping brackets are mounted on a thick-walled box section frame. Four rubber elements between each wide clamping bracket and the box section provide the discs with high penetration power.

TERRADISC

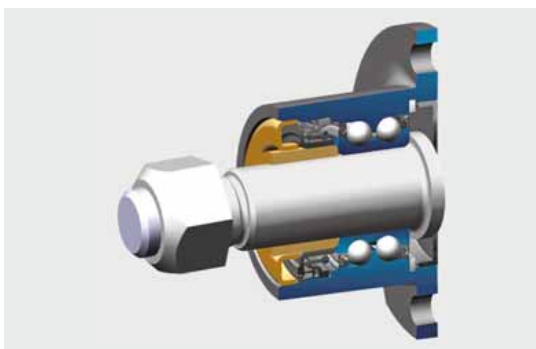

Fast operating speeds and working depths down to 4.72" / 120 mm mean the disc bearings have to withstand considerable stress. That is why PÖTTINGER has implemented high-quality bearings for an extended service life.

The special twin-race tapered bearings have been adopted from the construction machinery industry. Ruggedness and reliability are guaranteed as a result and impacts are absorbed perfectly.

- The sealed, twin-race tapered bearings are completely maintenance-free.
- A labyrinth seal provides perfect protection for the bearing.
- A metal cover encapsulates the labyrinth seal for additional protection.
- The bearings are fitted to the disc carrier arm by a stub axle.
- The nuts are protected by caps mounted on the same axle bolt.

Generous inter-disc clearance

Ideal cultivating results are achieved thanks to optimum spacing of the discs.

- Plenty of space between discs and carrier arms.
- The carrier arms are angled facing the direction of rotation so that there is no risk of stones or harvest trash becoming lodged between the disc and arm.
- A large clearance between the disc and clamping bracket means large quantities of organic matter can easily pass through.



Adjustable outer discs

On the left and right the outermost concave discs are depth adjustable. This means you achieve perfect merging of passes.





Convenient operation

The rear rollers assume the role of depth control for the disc harrow. Working depth is adjusted hydraulically and quickly without risk to the operator. The weight of the roller is transferred to the disc harrow during operation. Thus ensuring reliable penetration on dry and hard ground.

Convenient adjustment

Setting up for different soil conditions must be quick and straightforward. On the TERRADISC compact disc harrow that's conveniently solved with hydraulic depth adjustment.

- Folding 0.2" / 5 mm-thick swing clips are used to fine-tune depth control.
- The levelling tines are adjusted in unison with the roller mounting arms.
- No complicated manual intervention required – convenience that every tractor driver deserves.

Road Transport

The outer disc pairs are folded upwards hydraulically for transport on the road. The edging board is simply pushed inwards for transport widths of 9.84', 11.48' and 3.12' / 3.0 m, 3.5 m and 4.0 m.

- The TERRADISC 3501 can be transported on the road unaccompanied in situations where laws permit a width of 11.84' / 3.50 m.
- That offers up to 17 % higher output compared to a 9.84' / 3.0 m implement.



Edging boards as standard

For a uniform surface finish, adjustable edging boards are provided on both sides as standard equipment.



Levelling harrow

The optional spring steel levelling tines deflect the flow of soil to the rear roller, crumbling and levelling the ejected mixture of trash and soil. The height of the levelling tines, which are 0.55" / 14 mm thick and feature tangential geometry, is adjusted when the position of the rear roller is changed.

- The main height and angle settings are preset using a pin-in-hole matrix.
- The position of the tines changes in accordance with the working depth. The deeper the setting the easier the flow of material to the rear.



TERRADISC

Rigid-framed compact disc harrows



Adjustable headstock

TERRADISC 3001 / TERRADISC 3501 / TERRADISC 4001

Tractors with up to 190 hp have a huge range of hitch geometries. The range of mounting options offered by the headstock ensures excellent ground penetration and sufficient transport height.

Three lower linkage mounting heights with clevis-type mounting lugs are offered as standard. The headstock angle can be adjusted and with three top linkage positions optimum adaptation to any tractor is guaranteed.



Heavy duty frame

The compact frame is a trademark of the mounted TERRADISC harrow. Unique open frame design provides a perfect view of both disc gangs from the driver's seat.

- The first gang of discs is very close to the tractor for a very favourable centre of gravity.
- Compact, short design guarantees smooth and stable operation of the implement.



TERRADISC MULTILINE

Extend the range of applications for the
TERRADISC 3001 / 4001 with MULTILINE



Straightforward and compact

The TERRADISC MULTILINE is a trailed implement. This means that the load acting on the rear axle of the tractor is minimised. At headlands and during transport, the unit is lifted on the tyre packer. This ensures smooth running, high ground clearance, and a low soil compaction at headlands.

From stubble cultivation to mulch drilling

Within just a few minutes, the trailed disc harrow becomes an efficient, fully-functional mulch seed drill. The MULTILINE concept offers arable farmers a wide range of combination possibilities, meeting the demands of the market.

Flexible all-rounder

The VITASEM ADD or AEROSEM ADD seed drill is mounted on the packer. This allows the seed drill to be fitted or removed easily – depending on whether the disc harrow is to be used on its own or not. As a result, the MULTILINE combination is a real multi-talent with a wide range of applications.

Working cost-effectively

Moreover, trailed TERRADISC models can also be used on their own for shallow or deep soil cultivation. This allows high output to be achieved with smaller tractors.





The new tyre packer

At the headland and during transport, the TERRADISC MULTILINE is lifted by the offset tyre packer so the weight is distributed over the whole working width. The tyre packer ensures excellent handling on the road.

Offset tyre packer

Thanks to the offset wheel configuration, smooth operation in the field is guaranteed. Offset wheels need less pulling power because the packer tyres do not form a ridge or bow wave.

- Despite an offset of 19.69" / 500 mm, all the wheels are always on the ground.
- Large area of contact prevents harmful compaction.

Reliable and blockage-free operation

Each of the rear packer tyres has two scrapers to ensure tidy, blockage-free operation of the packer. The scrapers are raised automatically when the machine is lifted.

- The scraper beam is spring-loaded and adjustable in 5 positions.
- The springs also serve as overload protection in stony soils.
- No problems when driving backwards.
- It is also possible to operate with the scrapers raised.

Optional air or hydraulic brakes

- All wheels are braked.
- Enhanced safety during road transport also with a mounted seed drill.
- Good road handling.





TERRADISC K TERRADISC T

Folding compact disc harrows



The large folding disc harrows have been developed for high output stubble cultivation and general seedbed preparation.

**TERRADISC 4001 K / TERRADISC 5001 K / TERRADISC 6001 K
Mounted, folding compact disc harrows**

TERRADISC mounted disc harrows feature a compact frame. Three lower linkage heights with Cat. 2/2 and Cat. 3/3 clevis-type mounting lugs are standard. The three top linkage positions give optimum adjustment to fit all tractors.

Convenient operation

Working depth is quickly pre-set hydraulically without risk to the operator. Depth adjustment of the rear roller and levelling tines is fine-tuned using swing clips on the hydraulic cylinders. Access to the swing clips is easy and safe on both sides. The weight of the rear rollers is transferred to the disc harrow for reliable soil penetration.

Road Transport

Hydraulic folding enables convenient and trouble-free road transport at a width of 9.19' / 2.80 m. The disc harrows are folded in two halves to achieve a low transport height.

The automatic transport interlocks are operated by hydraulically actuated lock pins.

TERRADISC T



TERRADISC 4001 T / TERRADISC 5001 T / TERRADISC 6001 T **Trailed, folding compact disc harrows**

The transport chassis ensures that the weight acting on the hitch and rear axle of the tractor is minimised.

Practical drawbar

The drawbar is connected to the lower linkage and top linkage lugs. Optimum ground clearance at headlands and during transport can be adjusted precisely to each tractor thanks to a choice of top link positions. A drawbar and transport chassis can also be retro-fitted to TERRADISC K models for even greater flexibility.

- The linkage yoke is hooked up to the lower linkage using clevis-type mountings.
- A telescopic drawbar is also available. This enables a steering angle of 95° up to a tractor-overall width of 13.78' / 4.20 m.
- A ring hitch is also offered as an option.



Rugged transport chassis

The wheel chassis is mounted directly to the main frame and linked to the headstock. The wide chassis with 500/45-17 tyres travels smoothly on the road. Air brakes or hydraulic brakes are offered as additional equipment options. These systems enhance safety at maximum permissible speeds and together with the parking brake comply with all road safety legislation.



During operation the wheel chassis is folded far forwards in front of the rear roller. Trailed models also feature hydraulic accumulators for smooth operation in the field. The additional load acting on the disc harrow ensures reliable penetration in all soil conditions.

- The choice of rear rollers for trailed machinery includes a cage roller, double cage roller, pack ring roller, tandem CONOROLL and rubber packer roller.
- At the headland the TERRADISC T is raised onto the rear roller and its weight distributed across the whole working width.
- The trailed TERRADISC is therefore very light on its feet at headlands.
- A FRONTBOARD is available as an option to level the soil in front of the discs.

Tandem CONOROLL roller

The tandem CONOROLL consists of 2 rollers with strip thickness of 0.31" / 8 mm. The diameter of the rings is 22.04" / 560 mm. Ideally suited to trailed TERRADISC machines.

The rollers overlap each other and each has a footprint of 50 % of the working width. This also works well on light soil.

- The inclination of the roller can be quickly adjusted using a pin-in-hole matrix to allow for the working depth and operating conditions.
- No scrapers required; rollers self-clean effectively.
- Raised on rear roller at headlands, so there are no problems driving backwards.
- Side-mounted edging boards guarantee smooth operation in harvest residues and stony areas



TEGOSEM

Cover crop seeder



TEGOSEM 200 / TEGOSEM 500

The TEGOSEM catch crop sowing unit combines soil cultivation and sowing a cover crop in a single pass to save time and costs. The TEGOSEM can be combined with the PÖTTINGER SYNKRO stubble cultivators as well as with TERRADISC disc harrows. This new unit can be used together with three-point mounted implements and trailed machines.

Disc harrow	Mounting	TEGOSEM	Fan drive system	Hopper location	Volume gal / litres	Weight lbs / kg
TERRADISC 3001	Rigid 3-point	TEGOSEM 200	Electric	Rear roller	43.99 / 200	297 / 135
TERRADISC 3501	Rigid 3-point	TEGOSEM 200	Electric	Rear roller	43.99 / 200	297 / 135
TERRADISC 4001	Rigid 3-point	TEGOSEM 200	Electric	Rear roller	43.99 / 200	297 / 135
TERRADISC 4001 K	Folding 3-point	TEGOSEM 200	Electric	Central holder	43.99 / 200	297 / 135
TERRADISC 5001 K	Folding 3-point	TEGOSEM 200	Hydraulic	Central holder	43.99 / 200	297 / 135
TERRADISC 6001 K	Folding 3-point	TEGOSEM 200	Hydraulic	Central holder	43.99 / 200	297 / 135
TERRADISC 4001 T	Folding trailed	TEGOSEM 500	Hydraulic	Drawbar	132.08 / 500	529 / 240
TERRADISC 5001 T	Folding trailed	TEGOSEM 500	Hydraulic	Drawbar	132.08 / 500	529 / 240
TERRADISC 6001 T	Folding trailed	TEGOSEM 500	Hydraulic	Drawbar	132.08 / 500	529 / 240

TEGOSEM cover crop sowing system



Hydraulic or electric fan

The fan is driven electrically up to a working width of 13.12' / 4.0 metres and hydraulically when wider than 16.40' / 5.0 metres. For trailed stubble cultivators and disc harrows, such as the TERRADISC T, the TEGOSEM is only available with a hydraulically driven fan.

Standard equipment and controls

The TEGOSEM is operated from the driver's seat using a convenient control terminal.



Functions

- Metering shaft control & monitoring, Output rate electronically adjustable
- Display in kg/ha
- Priming function
- Headland management
- Automatic calibration
- Total hectare counter and daily hectare counter
- Calibration button -calibration at the press of a button
- Emptying function to drain seed tank
- Filling level sensor
- DGPS sensor for speed sensor
- Pressure supervisor on hydraulically driven blowers for trailed machines
- Sensors on top link or chassis for start/stop metering
- Safe access using platform
- Small and large seed metering wheels





Precision sowing

The seed material is distributed evenly with the TEGOSEM. The metering system is driven electrically. Two different metering cell wheels are provided as standard to ensure precision distribution for small or large seeds even at low seed rates. Eight outlets handle seed distribution.

Seed distribution

The seed material is distributed pneumatically using distribution plates. This guarantees pinpoint precision regardless of the wind conditions. The distributor plates are adjusted by changing the shaft angle.



Calibration

Calibration is easy: the calibration procedure is started at the press of a button. A calibration bag is provided as standard equipment. A logical guide makes each calibration step easy to follow.

Metering start/stop

A sensor on the top link detects when to start and stop metering. On trailed machines, this is detected using a load cell on the drawbar.





Rear rollers

For perfect results

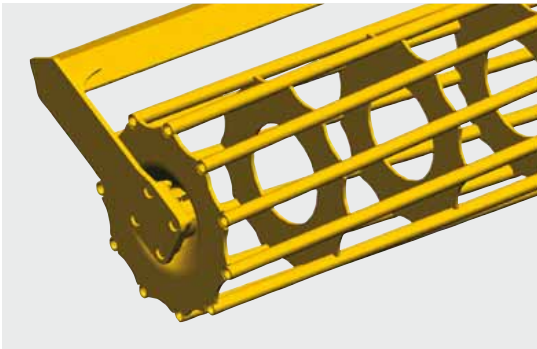

It's your choice. PÖTTINGER offers a wide range of rear rollers for perfect results with the desired tilth in any type of soil. The whole range of rollers features precision manufacturing and robust design engineering.

Cage roller

The ideal roller for dealing with dry, non-sticky soils. The roller is fitted with strong bars for optimal consolidation.

Diameter 21.26" / 540 mm, 11 bars;

Diameter 25.98" / 660 mm, 12 bars.

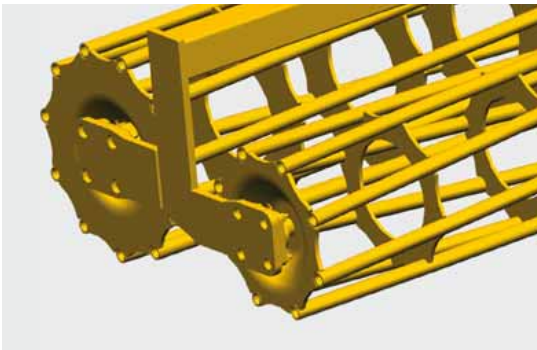

Double cage roller

The double cage roller is fitted with two different diameter rollers (21.26" front and 16.54" rear / 540 mm front and 420 mm rear). The pendular function ensures optimum ground tracking and perfect tilth.

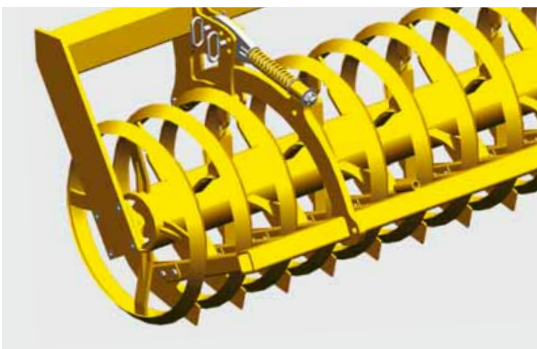

Knife ring roller

The advantages of the knife ring roller with a diameter of 21.26" / 540 mm include enhanced crumbling and re-consolidating by means of wedge-shaped rings.

The knives between the rings break up clods and keep the rings clean. Compression in strips has the advantage that water can be absorbed better. The right choice if you are working on dry and heavy soil.



Pack ring roller

The packer rings, which are enclosed, have a diameter of 21.65" / 550 mm with eight rings per metre of working width. The roller leaves behind consolidated ridges, promoting drainage and soil respiration. This is the ideal roller on stony, damp ground with large quantities of organic matter. The scrapers are coated for an extended working life.

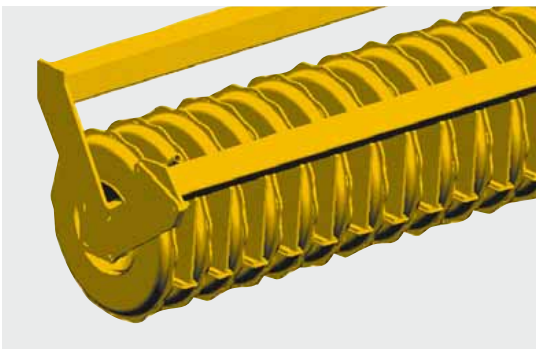

Rotopack roller

Rotopack rotors mix particularly intensively – for light to heavy, non-sticky soils. Harvest residues remain on the surface of the soil and protect your soil against drying out (only up to 9.84' / 3.0 m working width).

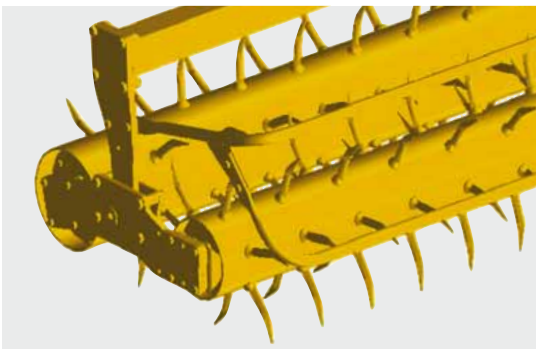

Rubber packer roller

The perfect roller for widely varied soil conditions. Especially for use with trailed implements where the load-bearing capacity of other rollers is near the limit. A diameter of 23.23" / 590 mm and the special profiling allows the soil to be compacted in rows. The scrapers are coated for an extended working life.



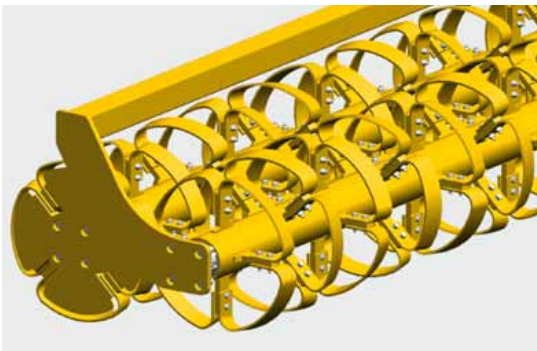
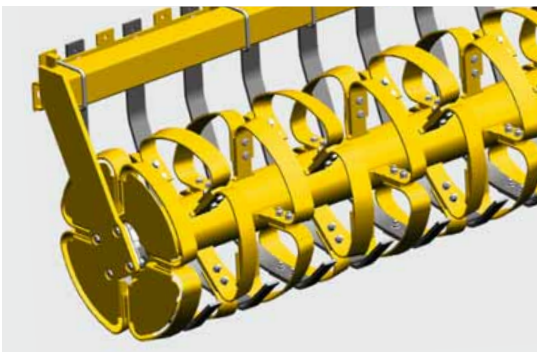

CONOROLL roller

This roller consists of rings with a diameter of 21.26" / 540 mm. Each ring is made up of four conical segments that are offset to the left and right. The result is a slot with alternate indentations on either side. When rainwater seeps into these indentations, they prevent it from flowing away. Erosion caused by rainfall is minimised thanks to the optimum structure created on the soil surface. The loose soil between the rings ensures good drainage.

The gap between each ring is 5.91" / 150 mm. Spring-mounted scrapers are located in between. These promote the formation of a fine tilth while keeping the space between the rings clean.

The load-bearing capacity of the CONOROLL is limited on very light soil. This is an ideal roller for medium to heavy soils. The side segments are covered. This guarantees trouble-free operation in harvest residues and stones.

Tandem CONOROLL roller

The tandem CONOROLL consists of 2 rollers. The diameter of the rings is 22.04" / 560 mm, strip thickness 0.31" / 8 mm. Ideally suited to trailed machines. (see page 13).

- The rollers overlap. Each has a footprint of 50% of the working width. Works well on light soil.
- The inclination of the roller can be adjusted to allow for the working depth and conditions.
- Rollers self-clean effectively, no scrapers required.
- Raised on rear roller at headlands, so there are no problems driving backwards.



Technical data

TERRADISC	3001	3501	4001	4001 K
Linkage	Cat. 2 / 2	Cat. 2 / 2	Cat. 3 / 3	Cat. 2 / 2
Working width, ft / m	9.84 / 3.0	11.48 / 3.5	13.12 / 4.0	13.12 / 4.0
Transport width, ft / m	9.84 / 3.0	11.48 / 3.5	13.12 / 4.0	9.19 / 2.80
Discs	24	28	32	32
Disc diameter, inch / mm	22.83 / 580	22.83 / 580	22.83 / 580	22.83 / 580
Disc spacing, inch / mm	4.92 / 125	4.92 / 125	4.92 / 125	4.92 / 125
Disc bearings	maintenance-free	maintenance-free	maintenance-free	maintenance-free
Gang spacing, inch / mm	35.43 / 900	35.43 / 900	35.43 / 900	35.43 / 900
Frame height, inch / mm	29.52 / 750	29.52 / 750	29.52 / 750	29.52 / 750
Power requirement from	70 kW / 95 hp	85 kW / 115 hp	100 kW / 135 hp	100 kW / 135 hp
Basic weight lbs / kg	3240 / 1470	3659 / 1660	4210 / 1910	5588 / 2535
Levelling harrow lbs / kg	125 / 57	185 / 84	200 / 91	200 / 91
Rear harrow lbs / kg	191 / 87	209 / 95	332 / 151	332 / 151
Cage roller 21.26" / 540 mm – lbs / kg	716 / 325	–	1058 / 480	1058 / 480
Cage roller 25.98" / 660 mm – lbs / kg	936 / 425	–	1344 / 610	1344 / 610
Double cage roller – lbs / kg	1146 / 520	–	1675 / 760	1675 / 760
Knife ring roller – lbs / kg	925 / 420	1036 / 470	1344 / 610	1344 / 610
Pack ring roller – lbs / kg	1311 / 595	1565 / 710	1807 / 820	1807 / 820
CONOROLL – lbs / kg	947 / 430	51124 / 510	1366 / 620	1366 / 620
Tandem CONOROLL	1510 / 685	–	2094 / 950	2094 / 950
Rubber packer roller	1234 / 560	–	–	–
Rotopack roller	881 / 400	–	–	–



4001 T	5001 K	5001 T	6001 K	6001 T
Cat. 3 / 2 / 3	Cat. 3 / 2 / 3	Cat. 3 / 2 / 3	Cat. 3 / 2 / 3	Cat. 3 / 2 / 3
13.12 / 4.0	16.40 / 5.0	16.40 / 5.0	19.69 / 6.0	19.69 / 6.0
9.19 / 2.80	9.19 / 2.80	9.19 / 2.80	9.19 / 2.80	9.19 / 2.80
32	40	40	48	48
22.83 / 580	22.83 / 580	22.83 / 580	22.83 / 580	22.83 / 580
4.92 / 125	4.92 / 125	4.92 / 125	4.92 / 125	4.92 / 125
maintenance-free	maintenance-free	maintenance-free	maintenance-free	maintenance-free
35.43 / 900	35.43 / 900	35.43 / 900	35.43 / 900	35.43 / 900
29.52 / 750	29.52 / 750	29.52 / 750	29.52 / 750	29.52 / 750
100 kW / 135 hp	125 kW / 170 hp	114 kW / 155 PS	140 kW / 190 hp	132 kW / 180 hp
8300 / 3765	6580 / 2985	9512 / 4315	7749 / 3515	10449 / 4740
200 / 91	238 / 108	238 / 108	253 / 115	253 / 115
-	368 / 167	-	392 / 178	-
-	1364 / 619	-	1499 / 680	-
1344 / 610	1688 / 766	1688 / 766	1873 / 850	1873 / 850
1675 / 760	1940 / 880	1940 / 880	2292 / 1040	2292 / 1040
-	1587 / 720	-	1851 / 840	-
1807 / 820	2226 / 1010	2226 / 1010	2623 / 1190	2623 / 1190
-	1631 / 740	-	1896 / 860	-
2094 / 950	2557 / 1160	2557 / 1160	3020 / 1370	3020 / 1370
-	2204 / 1000	2204 / 1000	2469 / 1120	2469 / 1120
-	-	-	-	-



Standard & Optional Equipment

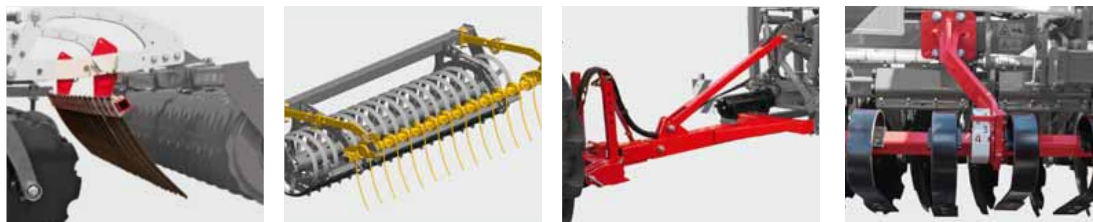

	Levelling harrow	Rear harrow	Telescopic drawbar	Frontboard
TERRADISC	<input type="checkbox"/>	<input type="checkbox"/>	-	-
TERRADISC K	<input type="checkbox"/>	<input type="checkbox"/>	-	-
TERRADISC T	<input type="checkbox"/>	-	<input type="checkbox"/>	<input type="checkbox"/>



	Pneumatic brake Hydraulic brake	Warning signs and lighting
TERRADISC	-	<input type="checkbox"/>
TERRADISC K	-	<input type="checkbox"/>
TERRADISC T	■	■

■ = Standard, □ = Optional

More equipment options

Telescopic drawbar with Cat. 4 lower linkage

Telescopic drawbar with Cat. 3 US coupling telescopic drawbar with ring hitch

Hydraulic cylinder for pivoting drawbar (recommended when using ring hitch).

TEGOSEM cover crop sowing system



Your machine goes online.

All the information on your machine
easily – anytime – anywhere

Simply scan the QR code on the **data plate** with your smartphone or tablet or enter your machine number at www.poettinger.at/poetpro. You will immediately receive all the information on your machine.

- Instruction manuals
- Optional equipment information
- Brochures
- Photos and videos



PÖTTINGER Spare parts service

- Worldwide network of sales and service partners.
- Decades of spare and wear parts availability.
- Original PÖTTINGER parts can be ordered online around the clock.

PÖTTINGER Landtechnik GmbH

Industriegelände 1
4710 Grieskirchen
Austria
Phone +43 7248 600-0
info@poettinger.at
www.poettinger.at

Alois PÖTTINGER UK Ltd.

15 St Marks Road, Corby
Northamptonshire,
NN18 8AN
United Kingdom
Phone + 44 1536 272 220
info.uk@pottingeruk.co.uk
www.pottingeruk.co.uk

PÖTTINGER Canada Inc.

650, Route 112
St-Cesaire, PQ J0L 1T0
Canada
Phone +1 450 469 5594
Fax +1 866 417 1683
info@poettinger.ca
www.poettinger.ca

PÖTTINGER US, Inc.

393 Pilot Drive
Valparaiso, IN 46383
USA
Phone +1 219 510-5534
Fax + 1 219 707-5412
info@poettinger.us
www.poettinger.us

PÖTTINGER Australia PTY LTD

11 Efficient Drive
Truganina VIC 3029
Australia
Phone +61 3 8353 2770
sales.au@poettinger.com.au
www.poettinger.com.au

PÖTTINGER Ireland Ltd.

Industrial Estate
Cashel Rd., Clonmel, Co. Tipperary
Ireland
Phone +353 52 6125766
info.ie@poettinger.at
www.poettinger.ie

Importer for New Zealand:

Origin Agroup
PO Box 673, 57 Hautapu Road
Cambridge
New Zealand
Phone +64 7 823 7582
info@originagroup.co.nz
www.originagroup.co.nz

Importer for South Africa:

VALTRAC
Cnr. Water & Buiten Street
9585 Parys
South Africa
Phone +27 56 817 7338 7308
wynn@valtrac.co.za
www.valtrac.co.za

